

# Door & Window Sensor

User manual



Hafele Smart Living



*Please read the instruction manual carefully before using the product*

## 1. Product specification

Product name	Door & window sensor
Power specification	CR2032, 1pc (replaceable)
Temperature detection range	-10°C - 45°C
Humidity detection range	5% - 90% RH (No condensation)
Wireless connection	ZigBee

## 2. Packing list

- Door & Window sensor x1
- Instruction manual x1

### 3. Product description

HÄFELE

The door and window sensor detects the opening or closing of the door and window and works in conjunction with other devices to design and implement smart application scenarios

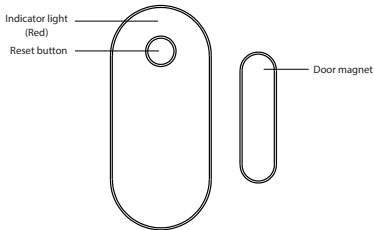

## 4. Installation

HÄFELE

Pull out the "Pull" tab on the sensor to activate the pre-installed battery.

Peel the tape liner off the back of the door and window sensor. Stick the door and window sensor on the door or window frame you want to secure.

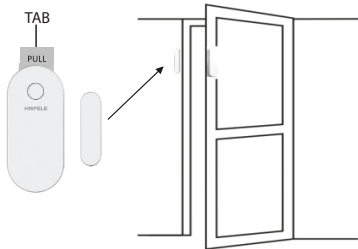

## 5. Preparation for use

- Mobile phone is connected to Wifi

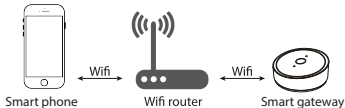

Ensure that the product is within the effective coverage of the Gateway to ensure an effective connection between the product and the Gateway.

*\* Make sure the Gateway has been added.*

## 5. Preparation for use

- Download and open the APP

In the App Store, search for "Hafele Smart Living" or scan the QR code on the manual to download and install the smart APP.

If you are downloading this App for the first time, please tap the "Sign up" button to register your account. If you are already have an account, click the "Login" button



Hafele Smart Living

## 6. Set up and Pairing

Please confirm that the battery is loaded while ensuring that the phone is connected to the network and the smart gateway has been added successfully

Open the APP and tap "Add subdevice" on the Gateway screen.

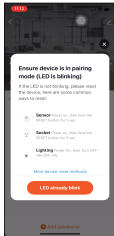
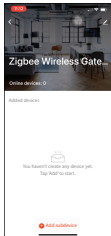

## 6. Set up and Pairing

Press and hold reset button for 5 seconds. The indicator will start to flash. Once the door and window sensor successfully connects, the light will turn off.

Press "Done" to back to the main screen. Touch the door and window sensor icon, you can see the door/window status which you are monitoring.

